

MS-MBA-2-L4

Lens Technology Enabled™ Multi-Beam Base-Station Antenna perfect for 6 sector LTE cell site deployments, utilizes a patented spherical lens design with 2 isolated low-frequency (698-960MHz) cross-polarized beams. Each beam has 4 cross-polarized ports for supporting 4x4 MIMO. Tilt is adjustable from 0 to 40° for each beam.

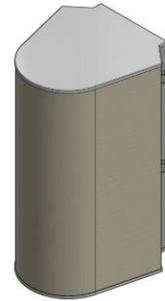

Select antenna profile type from the drop-down list:

MBA-2

Note: Dimensions on the drawing shown in mm

Antenna Model Number (optional)
MS-MBA-2-L4

Velocity
Select Measurement Unit: km/h
Velocity: 160

Dimensions
Select Measurement Unit: mm
Length: 1123

Length of antenna including end caps.
Do not include connectors, mounting brackets,
RET actuators/shrouds, lightning spikes
and other attached features.

Results			
	Frontal	Lateral	Rear
Profile Drag Coefficient	1.1	1.42	1.29
Antenna Correction Coefficient	0.6	0.6	0.6
Antenna Drag Coefficient	0.66	0.85	0.77
Wind Load (N/lbf)	548 / 123.2	787 / 176.9	642 / 144.3
Effective Drag Area(m ² /ft ²)	0.45 / 4.87	0.65 / 7	0.53 / 5.72